

Application

The thermowells model SI710G are screw-fitted into the process. They are suitable for high process loads, that might occur as a result of flow, temperature and process pressure influences or vibrations.

Standard features

Thermowell material

Stainless steel 316L
Stainless steel 316Ti

Process connection

½ NPT, ¾ NPT, 1 NPT

Instrument connection

Female thread ½ NPT

Bore size

Ø 6,6 mm, Ø 8,5 mm

Insertion length U

2 ¼", 4 ½" or 7 ½"
75, 100, 150 or 200 mm

Total length L

Insertion length + 1 ¼" (if dimensions in inches)
Insertion length + 50 mm (if dimensions in mm)

Maximum process temperature ¹⁾

600 °C

Maximum process pressure (static) ¹⁾

150 bar

Optional extras

- Other dimensions and materials
- Quality certificates
- Wake frequency calculations according to ASME / ANSI PTC 19.3 or to Dittrich / Klotter are recommended in critical applications. WIKA offer this as an engineering service. Following process data are necessary for the calculation:
 - Process pressure (in bar or psi)
 - Process temperature (in °C or °F)
 - Flow rate (in m/s)
 - Density (in kg/m³)
 - Dimensions and material of thermowell



1) Ratings depends on below parameters:

- Process medium
- Process pressure and temperature
- Flow rate
- Design of thermowell (dimensions, material)

OBSOLETE

Dimensions

Dimensions in mm								Weight in kg		
E	N	Ø d ₁	Ø F ₂	Ø F ₃	H ₁	T	SW	U = 2 ½ "	U = 7 ½ "	
½ NPT	½ NPT	6.6	16	13	19	1 ¾ " or 50 mm	27	0.200	0.360	
		8.5						0.190	0.320	
¾ NPT		6.6	22	16				36	0.310	0.560
		8.5							0.300	0.520
1 NPT		6.6	27	19				36	0.500	0.840
		8.5							0.510	0.880

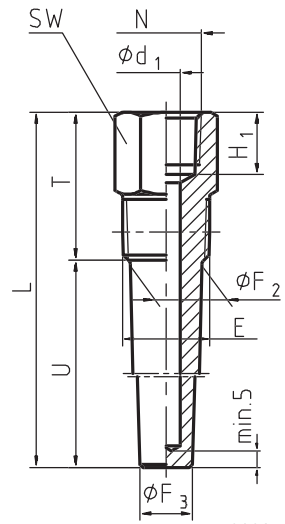

3236 561.01

Legend:

- E Process connection
- H₁ Bore depth for female thread
- L Total length
- N Instrument connection
- SW Across flats
- T Connection length
- U Insertion length
- Ø d₁ Bore size
- Ø F₂ Root diameter of thermowell
- Ø F₃ Tip diameter of thermowell

Suitable stem lengths of mechanical thermometers

Dial thermometers

Design of connection	Connection length T	Stem length l ₁	
S/4/5	T = 1 ¾ " (approx. 45 mm)	l ₁ = L - ¼ "	or l ₁ = U + 1 ½ "
	T = 50 mm	l ₁ = L - 5 mm	or l ₁ = U + 45 mm

Ordering information

State: Model / Material / Process connection / Instrument connection / Bore size / Insertion length U / Optional extras required

Specifications and dimensions given in this leaflet are correct at the time of printing. Modifications may take place and materials specified may be replaced by others without prior notice.



WIKAI Alexander Wiegand GmbH & Co. KG
 Alexander-Wiegand-Straße · 63911 Klingenberg
 ☎ (0 9372) 132-0 · ☎ (0 9372) 132-406/414
 http://www.wika.de · E-mail: info@wika.de